

Item
number: _____

Number: _____

DELI GROUP CO., LTD.

301 Xuxiake Ave. Ninghai County
Ningbo 315600 China Made in China
info@nbdeli.com www.deliworld.com



KEEP FOR FUTURE USE

Version: 1.0
Date: 02-2023

deli

USER MANUAL

Digital safe

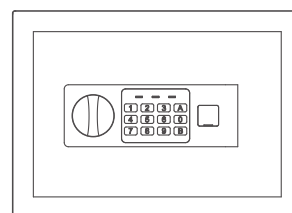

T521/T522/T523/T524/T525

Thank you for choosing Deli . Please read
this instruction carefully and follow it
before operating the safe.

DIRECTORY

Product unpacking.....	01
Product diagram.....	01
First use.....	02
Battery installation.....	02
Password setting	02
Open door operation	03
Closing operation	03
Replace the battery	03
Emergency opening	03
Product installation.....	04
Precautions for use	04

Product unpacking

After unpacking the package, please check whether the product appearance is intact and check all accessories. If there is any defect, please contact the dealer!



Manual 1 copy

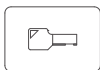

2 emergency keys

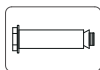

Expansion bolts 2 sets



4*AA Battery

Product diagram

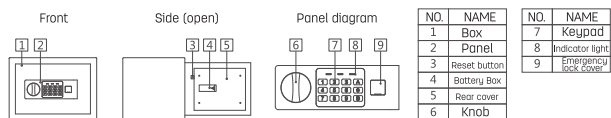

NO.	NAME
1	Box
2	Panel
3	Reset button
4	Battery Box
5	Rear cover
6	Knob

NO.	NAME
7	Keypad
8	Indicator light
9	Emergency lock cover

First opening

Push up the small cover plate on the right of the electronic panel to expose the emergency keyhole. Insert the emergency key and turn it counterclockwise. Then turn the knob clockwise to open the door.
Note: Please keep the emergency key and user manual in a safe place, but not in the safe.

Battery installation

The battery case is located behind the door. Remove the batteries box cover and place the batteries (4*1.5V, type AA) correctly according to the polarity. Always ensure you are using new batteries with full charge.

Password setting

The factory password is 159. For safety, please set your personal password in time. Press the reset button located in the back cover of the door, the system will beep once and yellow indicator light up. Input the new code (3-8 digits) and Press "A" or "B" on the electronic key pad as confirming, then the yellow indicator light will turn off. The new passcode is successfully set with a beep.
Note: Test the new passcode with the door open before locking the door.

Opening the safe

Input the correct password, press "A" or "B" key to confirm, the buzzer beep once and green indicator light turns on, please ensure turn the knob to open the door within 5 seconds. The safe will enter a 20 seconds lockout if the wrong passcode is entered 3 consecutive times. After the 20 seconds lockout it will automatically unlock.
Attention: Entering the wrong passcode 3 more times will lock the safe for 5 minutes.

Locking the safe

Simply close the door and turn the knob counter-clockwise.

Replace the battery

Press "A" or "B" key after passcode input, if the red indicator lights up when the green indicator light blinks, that's indicating low voltage. Please replace the batteries.

Emergency opening

The emergency keys allow you to open the safe at all times, even when the batteries are run out or you have forgotten the codes. The operation method is the same as "first opening".

Product installation

The product with predrilled mounting holes for easy fixing to a floor or wall with included expansion bolts.

Installation diagram

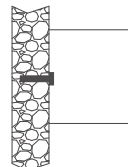

Precautions for use

Keep away from direct sunlight and heat sources, and prevent the product from falling from high altitude. Keep it in a safe place. If you do not use the product for a long time, please take out the battery to prevent leakage from damaging the electronic system.

DELI GROUP

WARRANTY CARD

Thank you for your purchase of our products. The interests of customers who purchase our products will be protected. For any malfunction due to product quality problems, please contact authorized local dealers or service centers with this receipt and the warranty card.

Warranty terms:

For product failures occur under normal operating circumstances, free of charge repair and spare parts replacement service shall be provided by our company within one year commencing from date of purchase. Customers are required to present this warranty card and the original purchase invoice to our company upon request for warranty service. This warranty card shall be valid only after the following form is filled out in details and affixed with official seal of the dealer.

No free of charge repair service shall be provided in the event of any of the following circumstances:

Expiration of the warranty period;
Damages caused by improper use, maintenance or storage not in accordance with the requirements of the user manual;
Failure or damage resulting from unauthorized disassembly, repair or modification;
Failure or damage caused by force majeure;
Wear parts or accessories.

This warranty card is being delivered with the product, one card for one product. Please keep this warranty card in proper condition for free warranty service. There is no replacement if lost.

Date of Purchase: Y M D

DELI GROUP

WARRANTY CARD

Product Information	Product Name		Serial Number		
	Product Model Number		Manufacturing Date		
Customer Information	Company Name			Contact	
	Address			Phone	
Sales Information	Dealer Name			Contact	
	Address			Phone	
	Date of Purchase			Invoice No.	
Maintenance Record	Description of Malfunction	Maintenance Results	Customer Signature	Maintenance Technician Signature	Maintenance Date

DELI GROUP

WARRANTY CARD

Product Information	Product Name		Serial Number		
	Product Model Number		Manufacturing Date		
Customer Information	Company Name			Contact	
	Address			Phone	
Sales Information	Dealer Name			Contact	
	Address			Phone	
	Date of Purchase			Invoice No.	
Maintenance Record	Description of Malfunction	Maintenance Results	Customer Signature	Maintenance Technician Signature	Maintenance Date

This copy shall be cut along the dotted line and kept by the dealer.